

带座外球面球轴承

UCP2立式带座外球面向心球轴承组件

带止动螺钉-UC210D1+UCP210D1+P210D1Z(ZM)-UCP210D1C(CM)-UCP210D1

参数信息:

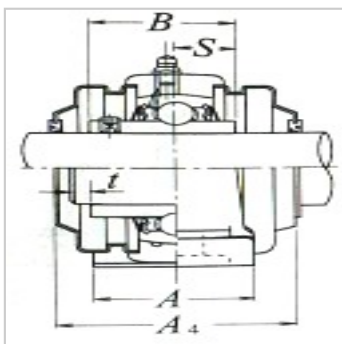
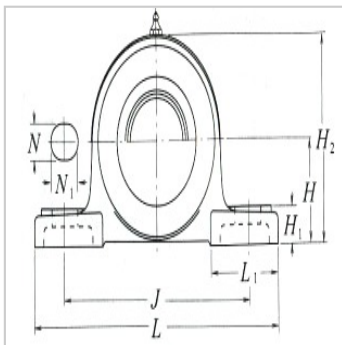
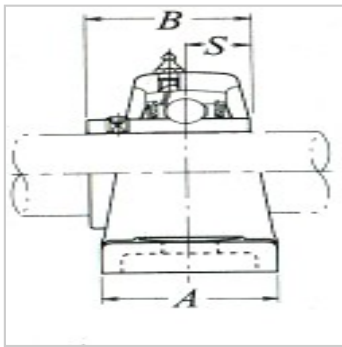
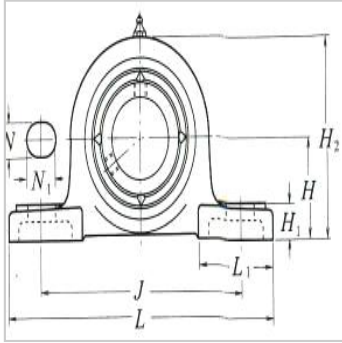

轴径inch :	50
座组件轴承型号(1) :	UCP210D1
尺寸inch :	
H :	57.2
L :	206
J :	159
A :	60
N :	20
N :	23
H :	21
H :	114
L :	65
B :	51.6
S :	19
安装螺栓规格inch :	M16
轴承代号 :	UC210D1
座外型号 :	P210D1
带钢板外罩座组件轴承型号 :	Z(ZM)-UCP210D1
带铸铁外罩座组件轴承型号 :	C(CM)-UCP210D1
尺寸inch :	
t(最大) :	3
A :	76
H :	119
A :	100
带座轴承重量lb :	
UCP :	2.6
Z(ZM) :	2.8

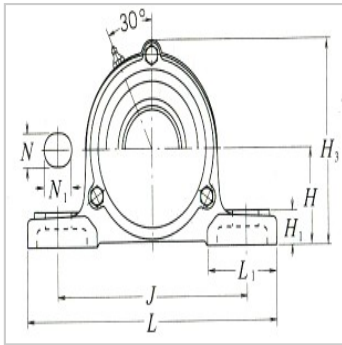

C(CM) :

4.3

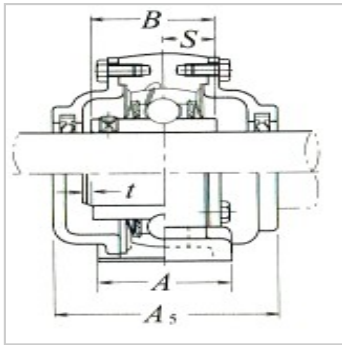

: